

EZ-GO ADAPTER CUP BUMPER INSTALLATION- INSTRUCTIONS FOR USE

The lock pin on the EZ-Go adapter cup protrudes beyond the adapter cup and can be damaged when impacted by other objects. This document describes how to install a protective bumper to the adapter cup for a boom installation and for a bed installation.

EZ-Go Bumper Kits

Part Numbers:

- Boom adapter bumper kit: 92-10-004



- Bed adapter bumper kit: 92-10-005

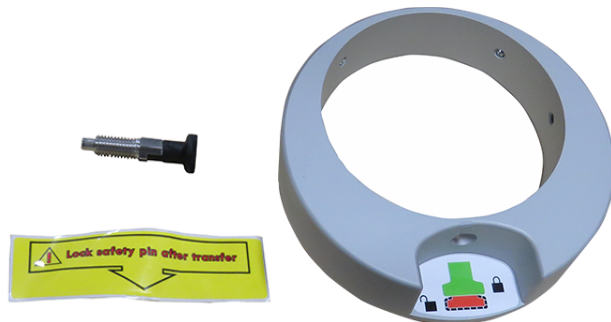

The EZ-Go bumper kits include:

- EZ-Go bumper
- Lock pin reminder sticker
- Lock pin

Required Tools

- 10mm wrench
- 3mm Allen wrench

Install the Bumper on Boom Adapter Cups

Make sure to install the bumper kit used for boom adapter cups, part number 92-10-004

1. Undock the EZ-Go from the boom mounted adapter cup (Figure 1).

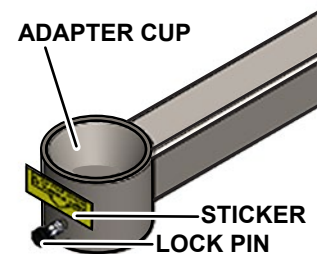

Figure 1. Adapter Cup Components

2. Remove the sticker from the adapter cup.
3. Using a 10mm wrench, remove the lock pin from the adapter cup.

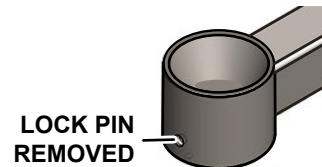

Figure 2. Pin Removed from Adapter Cup

4. Slide the bumper (PN/ 92-10-004) down over the adapter cup (Figure 3).

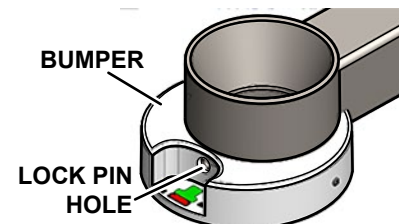

Figure 3. Bumper on the Adapter Cup

5. Align the bumper and adapter cup lock pin holes.

- Using a 10mm wrench install the lock pin.

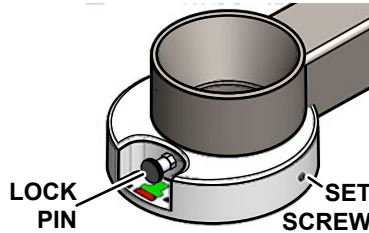

Figure 4. Bumper and Lock Pin

- Using a 3mm Allen wrench, tighten the four set screws located along the side of the bumper (Figure 4).

- Place the sticker on the adapter cup so that the arrow on the sticker is pointing at the lock pin.

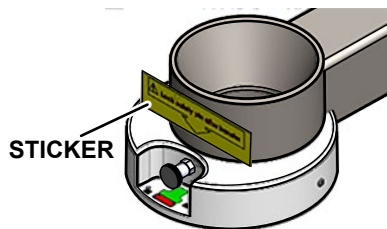

Figure 5. Lock Pin Safety Sticker

- Dock the EZ-Go to the adapter cup.

Install the Bumper on Bed Adapter Cups

Make sure to install the bumper kit used for bed adapter cups, part number 92-10-005

- Undock the EZ-Go from the adapter cup.

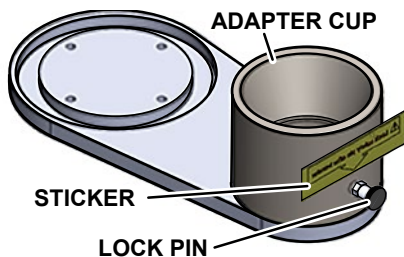

Figure 6. Adapter Cup Components

- Remove the sticker from the adapter cup.
- Using a 10mm wrench remove the lock pin from the adapter cup.

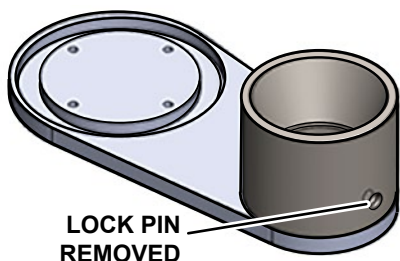

Figure 7. Lock Pin Removed

- Slide the bumper (P/N 92-10-005) down over the adapter cup.

NOTICE

Make sure the adapter cup is mounted on the bed adapter plate so the lock pin faces away from the plate as shown in Figure 6. If it is not, re-position the adapter cup so it is oriented as shown in Figure 6.

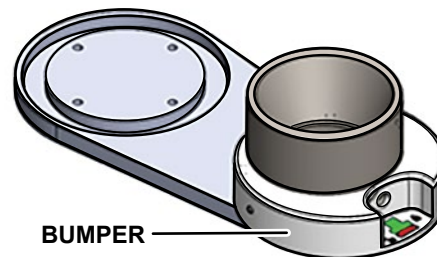

Figure 8. Bumper on the Bed Mounted Adapter Cup

- Align the bumper and adapter cup lock pin holes.

- Using a 10mm wrench install the lock pin.

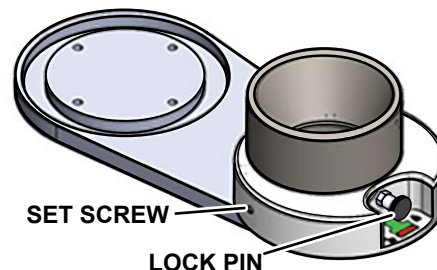

Figure 9. Bumper and Lock Pin

- Using a 3mm Allen wrench, tighten the four set screws located along the side of the bumper (Figure 9).

- Place the sticker on the adapter cup so that the arrow on the sticker is pointing at the lock pin (Figure 10).

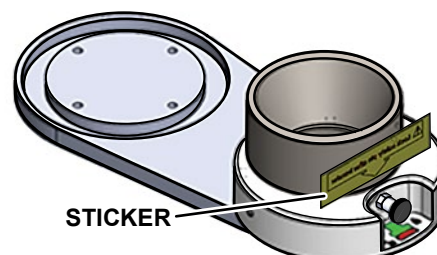

Figure 10. Replace the Sticker

- Dock the EZ-Go to the adapter cup.

Product Label

Boom Adapter Bumper Label



Bed Adapter Bumper Label



Revision History

Date	Revision	Revision History
07/05/2017	0	Initial Release

Distributed by:

US - SKYTRON

5085 Corporate Exchange Blvd. S.E.

Grand Rapids, MI 49512 (616) 656-2900

www.skytron.us

Manufactured by:

IHBO BV

Floresstraat 52

8022 AD Zwolle

The Netherlands



5085 Corporate Exchange Blvd. S.E.
Grand Rapids, MI 49512 • 616.656.2900