

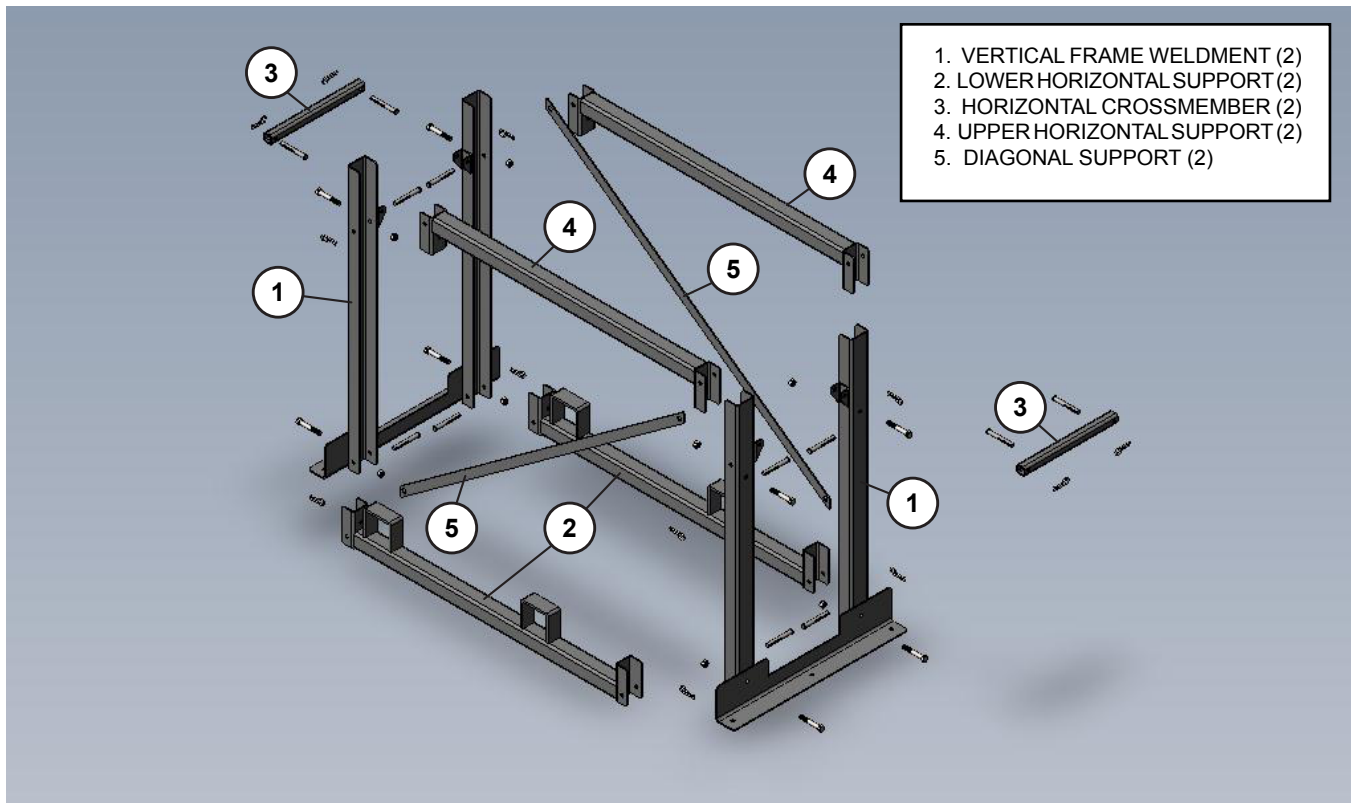

5085 Corporate Exchange Blvd. S.E.  
Grand Rapids, MI 49512 • 616.656.2900

## BOOM SHIPPING FRAME ASSEMBLY - INSTRUCTIONS FOR USE



### Hardware Needed for Assembly:

- (14) Clevis pins
- (14) R clips
- (8) 3/8" bolts with washers and nylon lock nuts
- (3) 3/8" x 3" carriage bolts with lock washers and nuts
- (3) 3/8" x 5" carriage bolts with lock washers and nuts

### Step 1: Opening the Crate

- a. Remove the (6) Phillips head screws and washers that secure the crate top in place. Remove the crate top.
- b. Remove the (4) Phillips head screws/washers and (2) 7/16" lag bolts/washers that secure the cardboard to the pallet. Lift the corrugated sides up and over the arms frame.
- c. Remove the (6) 3/8" nuts and washers that secure the frame to the pallet via 3/8" carriage bolts.
- d. The crate is now ready for Step 2.

## Step 2: Preparation of Frame for Installing Arm Set

- Remove the clips from the clevis pins secure the diagonal stabilizers to the frame. After removing of the stabilizers, replace the clips on the clevis pins.
- Insert forks of a Genie™ Lift or fork truck into fork pockets on frame. Raise frame enough to separate the frame from the pallet. Remove the pallet.
- Use the Genie™ Lift to raise the frame with the arms and properly align the hub of the arm set with the mounting plate.
- Remove all (8) 3/8" bolts and 3/8" nuts that are used to secure the upper and lower horizontal frame pieces to the vertical frame weldment (Figure 1).

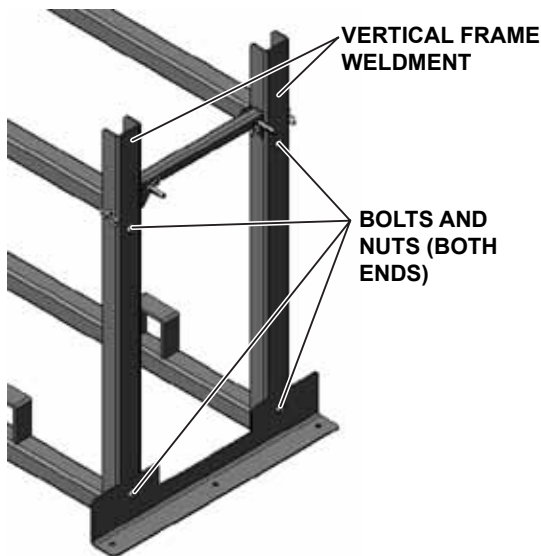

**Figure 1. Remove 3/8" Nuts and Bolts**

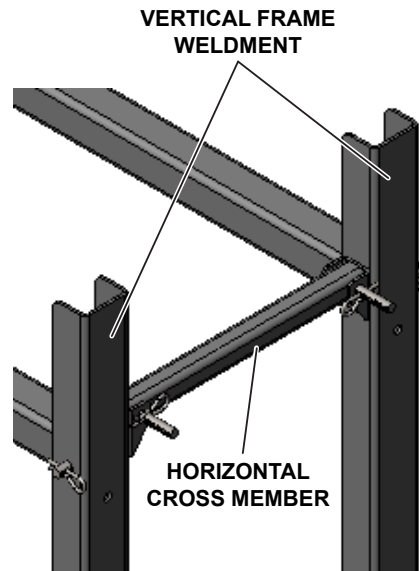

**Figure 2. Remove Crossmembers**

- Remove nylon strapping that secures the arms to the frame. Continue raising the arm frame until the bolt holes in the arm hub align with the threaded rods extending from the mounting plate. Install and tighten 1-1/4" nuts to the threaded rods per boom installation instructions.
- Disassemble each upper horizontal crossmember by removing the clevis pins and clips securing it vertical frame weldment (Figure 2).
- Lower the frame down and away from the installed arm set.

## Step 3: Disassemble the Arm Frame and Prepare for Return Shipment

- Disassemble each upper horizontal support frame piece by removing the clevis pins and clips that secure it to the vertical frame weldment. Repeat for the lower horizontal support frame pieces.
- Assemble the pieces as shown in Figures 3 through 7. The entire frame should fit together in a flattened condition as shown in Figure 7.
- Place the flattened frame into the shipping box. As an option, if more than 6 frames were used on the project, the knocked down frames can be attached to a pallet for return.
- Individual boxes can be returned Fedex (per the shipping label). If you secured the frames to a pallet, please call your Skytron CSR for pickup instructions.

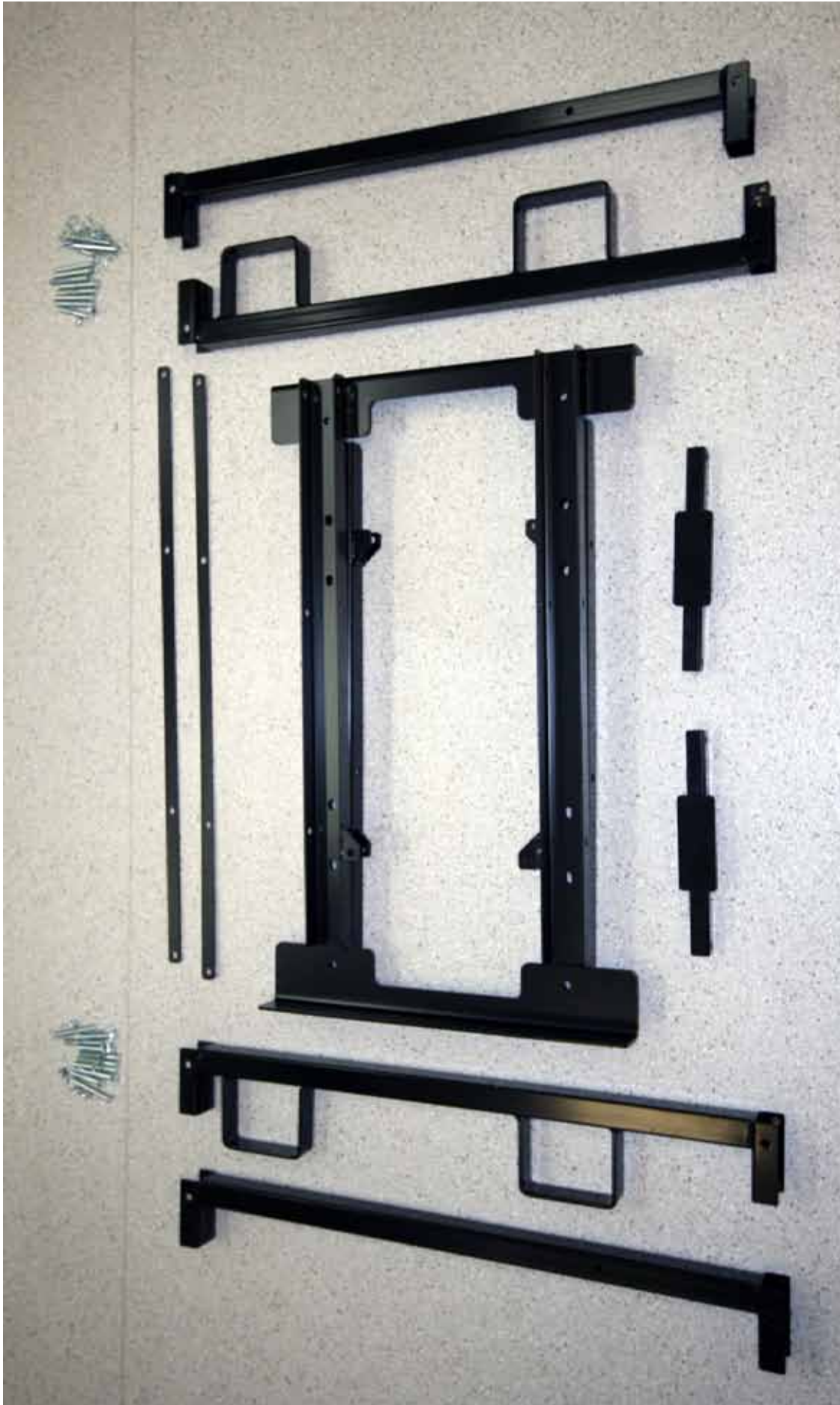
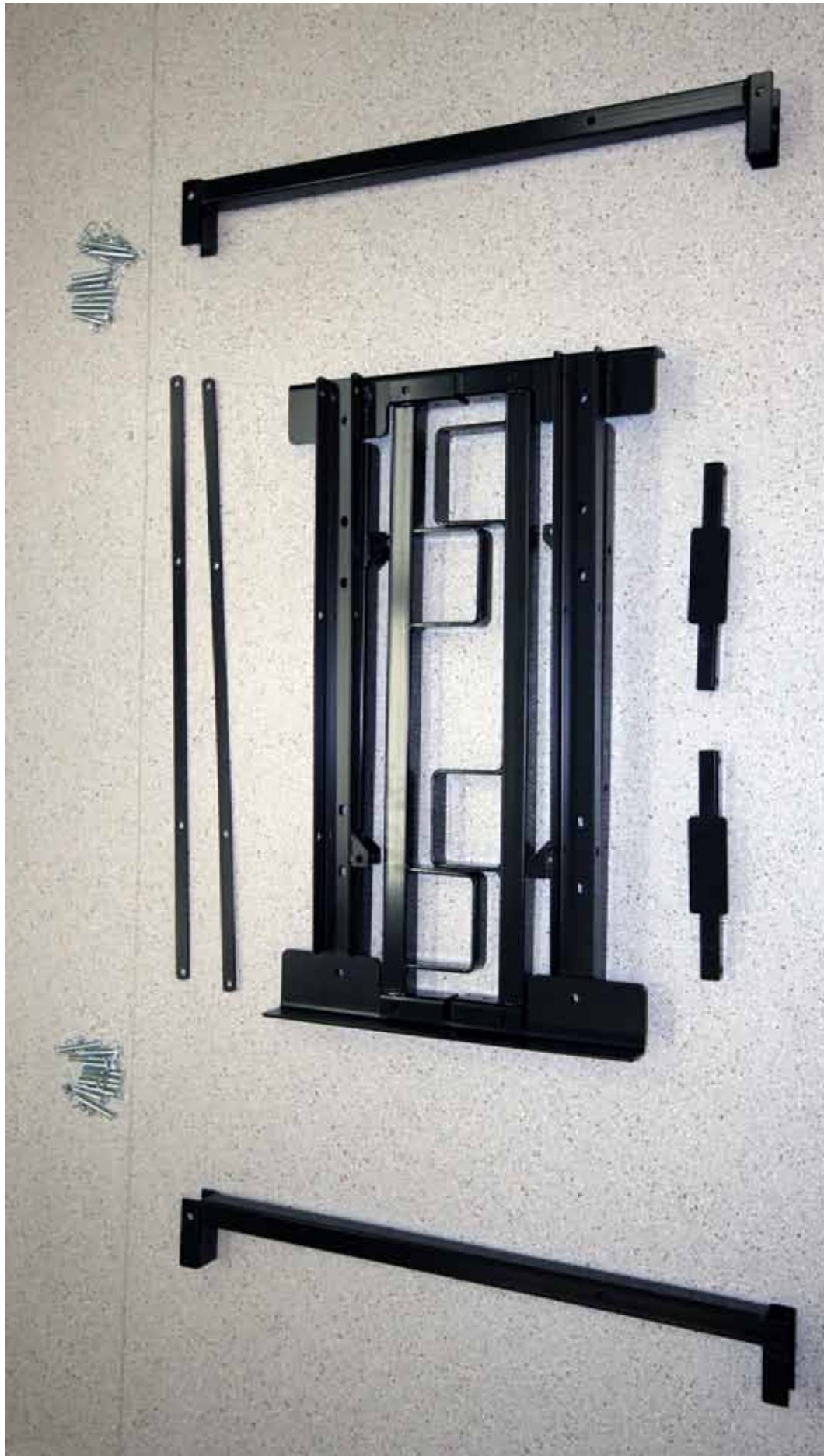

Figure 3. Frame Pieces and Hardware (Vertical Frame Weldments Aligned)





**Figure 4. Place Lower Horizontal Supports Inside Frame**

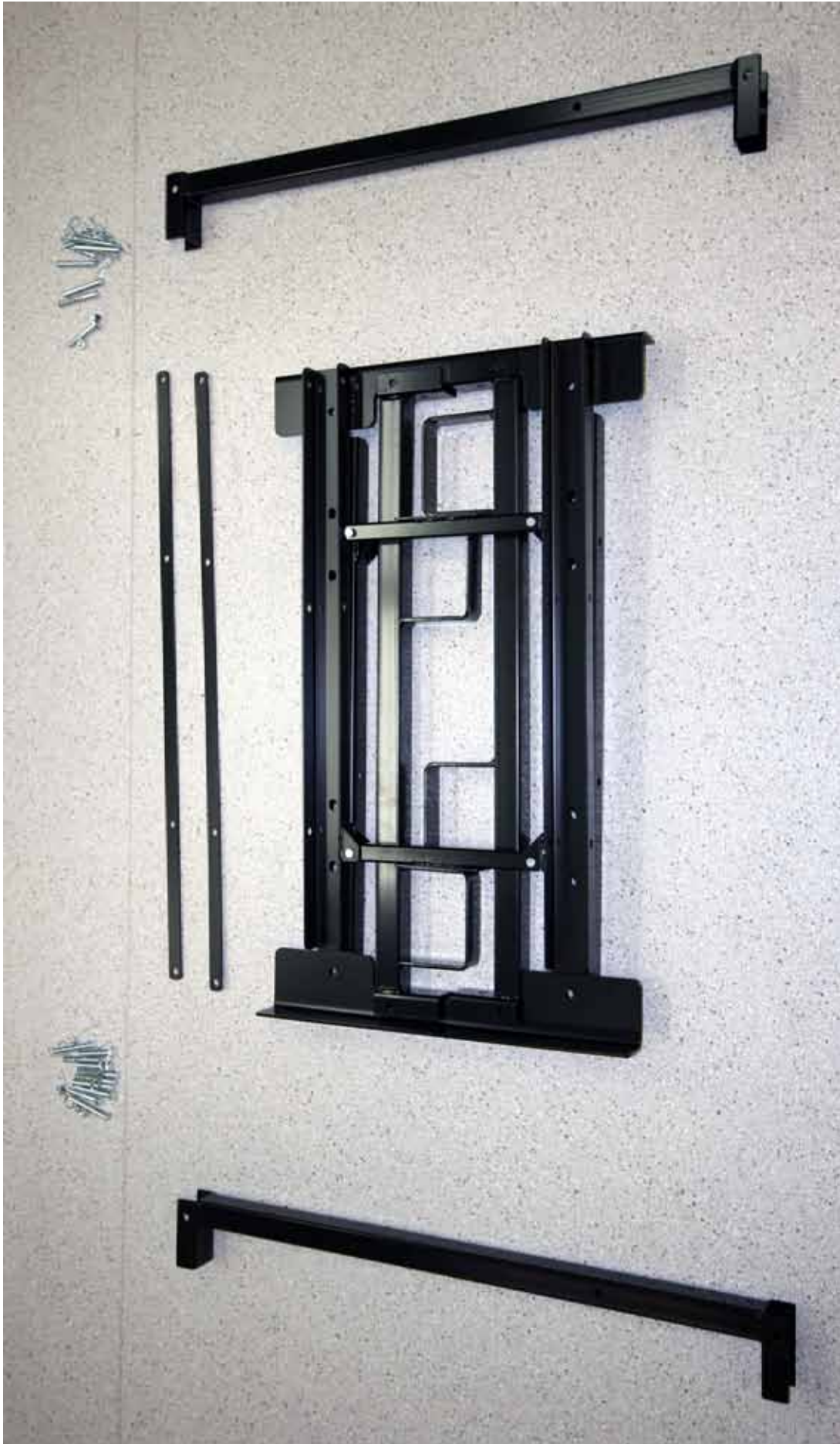

Figure 5. Assemble Horizontal Crossmembers



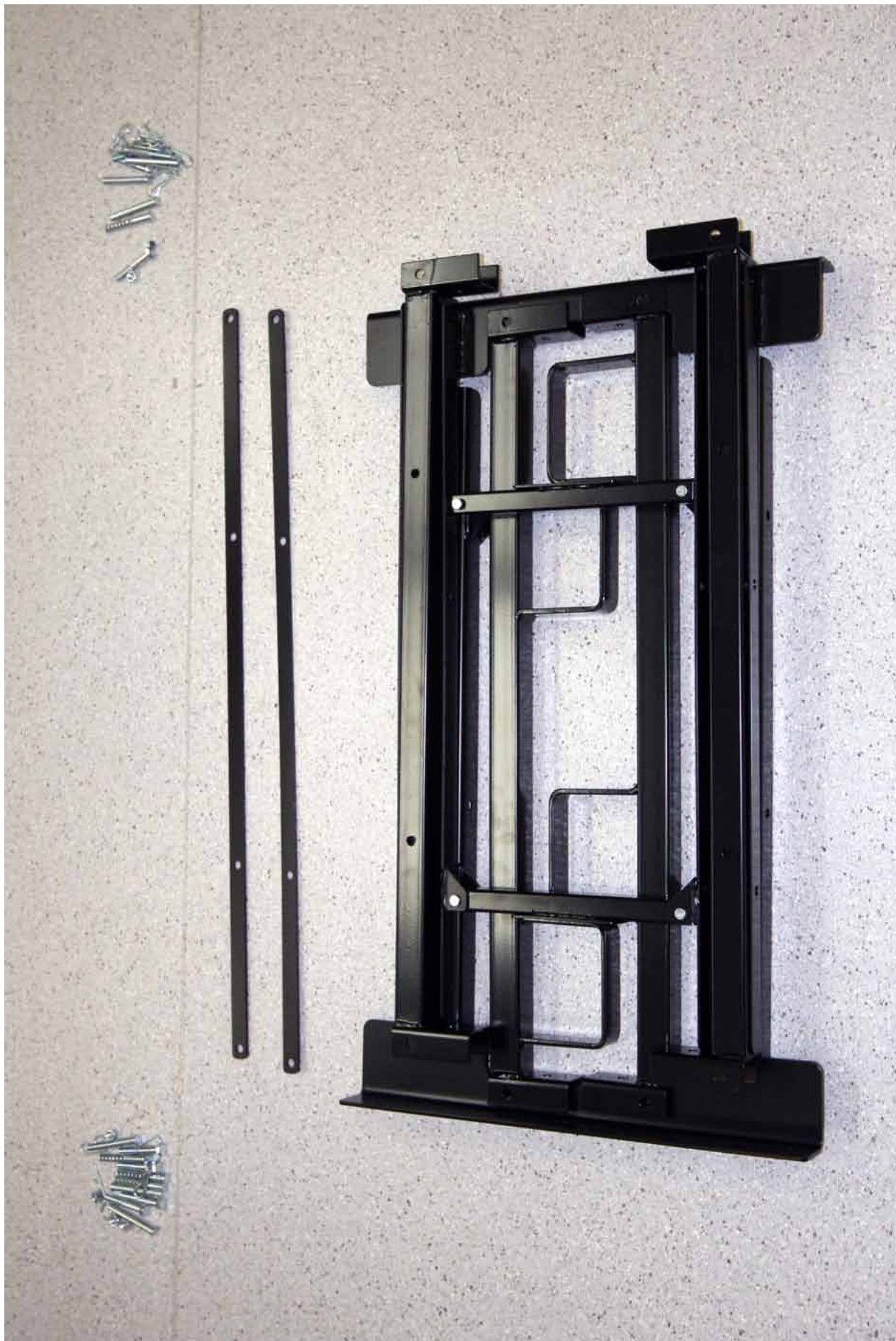

Figure 6. Align Upper Horizontal Supports With Frame



Figure 7. Align Diagonal Supports and Pin Together



5085 Corporate Exchange Blvd. S.E.  
Grand Rapids, MI 49512 • 616.656.2900 • FAX 616.656.2906